

4

3

2

1

NOTE(S):  
1. MAXIMUM WEIGHT 17.30 OZ.

2. POWER REQUIREMENTS:  
THIS CONTROL HEAD IS POWERED BY  
28VDC WITH A NOMINAL CURRENT OF  
0.32 AMPS AND 0.64 AMPS MAX.

REVISIONS			
REV	DESCRIPTION	DATE	APPROVED
A	ADD NOTES 1 & 2 AND LABEL ANNOTATIONS	12-13-03	D. CAPKA
B	CHG MOUNTING FASTENER - WAS SOC HD CAP.	7-12-04	D. CAPKA

CONNECTOR J1 - 15 PINS, KYCON P/N KF85-AD-15P (SIMILAR TO M24308/24-26)  
MATES WITH - ITT P/N DAA15SA197FO

Pin	Function	Pin	Function
1		9	
2	IR GND	10	IR 5V
3	IR IN	11	
4	RS485 HIGH	12	RS485 LOW
5	RS485 SHIELD	13	
6		14	
7	POWER ENABLE	15	POWER GND
8	28VDC INPUT		

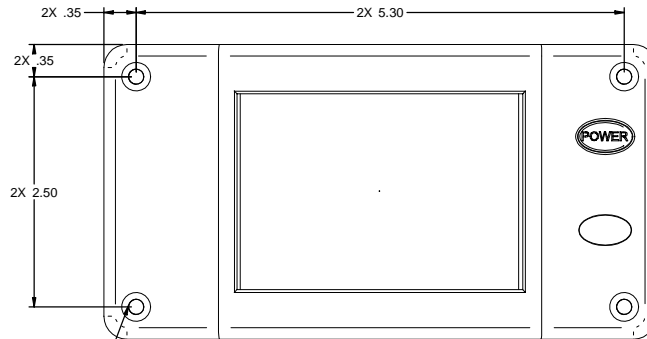
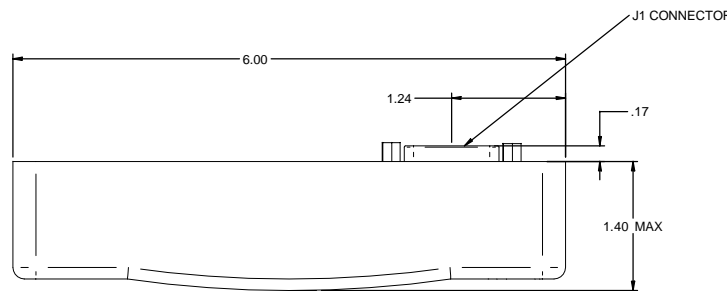
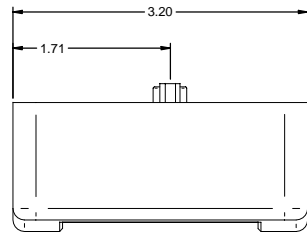
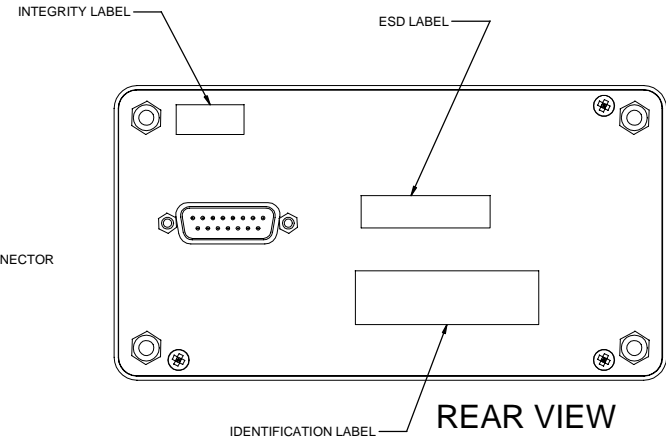

MOUNT USING 6-32 SOCKET BUTTON  
HEAD SCREW BY 1.5 INCHES LONG

MOUNTING HOLE LOCATION

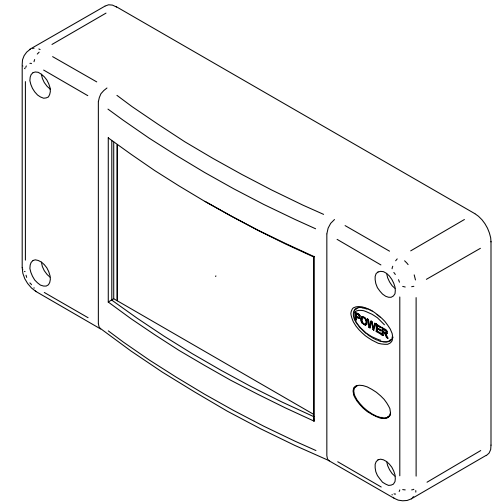

QTY	ITEM NO	PART NUMBER	DESCRIPTION	SPECIFICATION	NOTES
PARTS LIST					
UNLESS OTHERWISE SPECIFIED • DIMENSIONS ARE IN INCHES • TOLERANCES: ANGLES ± 1° 3 PLACE DECIMALS ± .010 2 PLACE DECIMALS ± .02 • INTERPRET DRAWINGS PER DODD-1000 • REMOVE ALL BURRS AND SHARP EDGES • CONCENTRICITY MACHINED DIMENSES .010 FIM • DIMENSIONAL LIMITS APPLY BEFORE PROCESSES • PARENTHEICAL INFO FOR REF ONLY			DWN: D. CAPKA DATE: 7-23-03 CHECK: D. CAPKA DATE: 7-23-03 ENGR: D. CAPKA DATE: 7-23-03 APPROVED: DATE: RELEASED: DATE:	 2033 Chevrolet Drive Suite 100 Carrollton, TX 75006 (214) 407-1131	
HOLE DIAMETER TOLERANCE			DRAWING NO		
.013 THRU .024 128 .005 THRU .001 1.000			XMC100-01-ICD		
.024 THRU .031 750U .001 1.000			CONTRACT:		
.031 THRU .038 751 1.001 .012			PROJECT:		
.038 THRU .041 1.000 .001 2.000			SCALE: NONE REV: B SHEET NO 1 OF 1		
USED ON NEXT ASSY			SIGNATURES ON FILE		

SEQ NO	PROCESS	ADDITIONAL	NOTES

4

3

2

1

CAD GENERATED DRAWING

BH  
BY/CHKD

A  
B  
C  
A